

**ZIP-RIB®**

**#306 Standing Seam Panel**

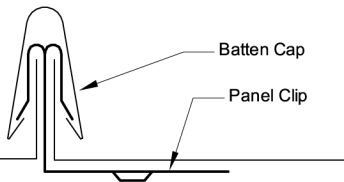
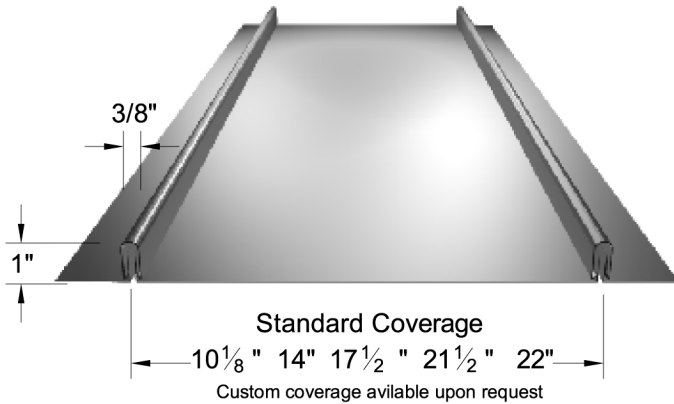

**Panel Side Joint**

Traditional narrow seam snap on batten. Available in a variety of coverages. Alternative seam height available.

**Applications**

Architectural roofing on slopes 3" or greater. Continuous lengths up to 45 ft. Vertical walls, conical tapers and radius barrels.

**Substrates**

Solid deck plywood or rigid insulation over decking. Requires minimum 30# felt underlayment and rosin slip sheet.

**Materials**

Aluminum (3000 series alloy)  
Galvanized coated steel (G-90)  
Alum-Zinc coated steel (AZ-50 & AZ-55)  
Copper & lead coated Copper  
Also available in Zinc & Pre-Weathered Zinc

**Standard Gauges**

.032" .040"  
24 ga. 22 ga.  
24 ga. 22 ga.  
16 oz. 20 oz.

**Finishes**

Kynar & Metallic Fluoropolymer Coatings  
Mill Finish, Brushed, Anodized  
Texture: Smooth or Stucco Embossed

**Manufacturing**

Factory Formed  
Factory & Field Curved

**Testing / Agency Approvals**

UL-90 Uplift                      ASTM E-331                      ASTM E-283

Some panels configurations are not suitable for all applications. Contact sales & engineering for more information.

**Components**

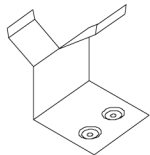

**#306 Clip**

One piece 24 gauge galvanized steel clip. Allows for free movement of panels during thermal expansion and contraction. Also available in Stainless Steel.

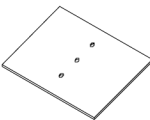

**Punched Bearing Plate**

6" x 6" 22 ga. galvanized. For clip support over rigid insulation.

**Seam Trim**

Rib knee transition. Supplied in 10'-0" lengths.



**S-5-U HD Clamp**

Aluminum block for use with S-5!™ snow retention system and for other practical purposes.

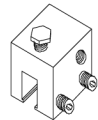

**S-5!™ ColorGard Snow Retention System**

Refer to PS-12 for more information.

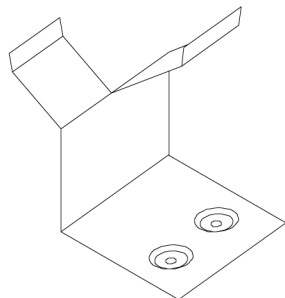
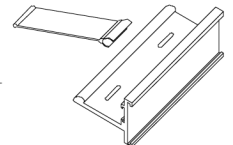

Before Closing

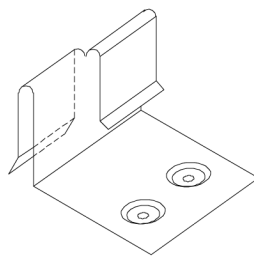

After Closing

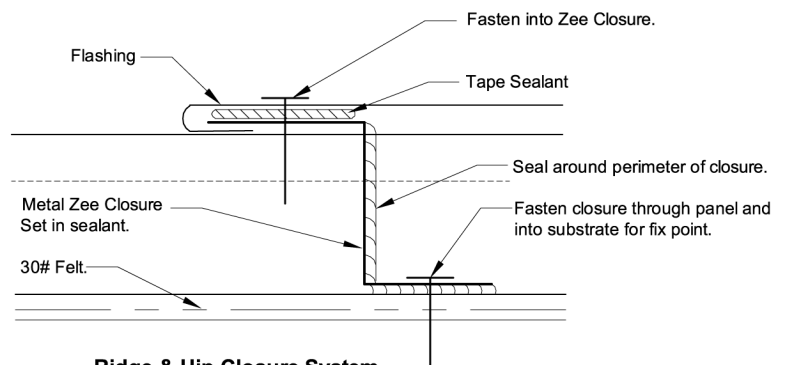

**Ridge & Hip Closure System**

10' metal Zee closure. Cut to suit between panel ribs.

